



規格尺寸對照 止漏管夾/銜接管夾

Item No.	Pipe Outside Diameter 管外徑			Coupling / Clamping Range (mm) 夾接範圍OD			Max. WP (bar) 最大工作壓力		Product Length (mm) 產品長度L		
	ND	Inch	Actual OD (mm)	MJG / MJGL / MGLP MJSG / MJSGL / MJET	MJS / MJL / MJR / MJRL MJH / MJHL / MJHT	MJD / MJDL / MJER	Ship 船	Industry 一般工業	MJER 彎管版	Standard 標準版	Long 加長版
U2	13A-1		15.8	-	MJH: 14.0 ~ 16.5	14.0 ~ 17.0					
01	15A	1/2	21.3 21.7 21.8	21.2 ~ 22.0	21.0 ~ 22.0 MJH: 21.0 ~ 23.0	21.0 ~ 23.0					
02	15A-2		20.0	19.5 ~ 20.5	19.5 ~ 20.5	19.5 ~ 21.3					
03	15A-3		22.2	21.2 ~ 22.5	21.2 ~ 22.7 MJH: 15A-1	(15A-1)					
04	20A	3/4	26.7 26.9 27.2	26.7 ~ 27.7	26.0 ~ 28.0	26.0 ~ 29.0					
05	20A-2		25.0	24.5 ~ 25.5	24.0 ~ 26.0	24.0 ~ 26.5					
06	20A-3		28.2 28.6	27.5 ~ 29.0	26.4 ~ 29.0	26.4 ~ 29.5					
07	25A	1	33.4 33.7 34.0	33.0 ~ 34.6	33.0 ~ 35.0	33.0 ~ 35.5			27	60	100
08	25A-2		30.0 30.2	29.5 ~ 30.5	29.0 ~ 31.0	29.0 ~ 31.5					
09	25A-3		32.0	31.5 ~ 32.5	31.0 ~ 33.0	31.0 ~ 33.5					
N9	25A-4		35.0	34.5 ~ 35.5	34.0 ~ 36.0	(25A-1)	16	32			
10	32A-1		38.0 38.5	37.5 ~ 38.5	37.0 ~ 39.0	37.0 ~ 39.5					
11	32A	1 1/4	42.2 42.4 42.7	41.9 ~ 43.0	42.0 ~ 44.0	41.0 ~ 44.5					
12	32A-3		44.5	44.0 ~ 45.0	44.0 ~ 46.0	44.0 ~ 46.5					
13	32A-4		40.0 40.9 41.3	39.5 ~ 41.5	39.5 ~ 41.5	39.5 ~ 41.8					
15	40A	1 1/2	48.3 48.6	47.8 ~ 49.0	47.5 ~ 49.5	47.5 ~ 50.5					
17	40A-3		50.0 50.8	49.5 ~ 51.5	49.2 ~ 51.5	48.6 ~ 51.5					
18	50A-1		54.0	53.4 ~ 54.6	53.0 ~ 55.0	53.0 ~ 56.0					
19	50A-2		57.0	56.4 ~ 57.6	56.0 ~ 58.0	56.0 ~ 59.0			40	80	150
20	50A	2	60.3 60.5	59.0 ~ 61.5	59.0 ~ 61.5	59.0 ~ 62.0					
21	50A-4		63.0	62.4 ~ 63.6	62.0 ~ 64.0	62.0 ~ 65.0					

藍字粗體標示為標準尺寸

船用爆破壓力 \geq 工作壓力 x 安全係數 (4)

工業用爆破壓力 \geq 工作壓力 x 安全係數 (2)

※不建議在食品輸送管線使用，橡膠墊圈可能會導致堵塞及腐爛。

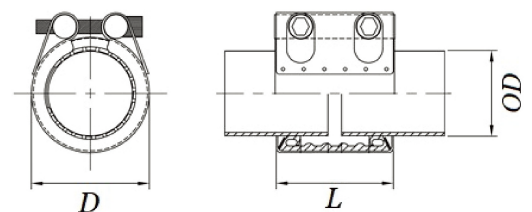



規格尺寸對照 止漏管夾/銜接管夾

Item No.	Pipe Outside Diameter 管外徑			Coupling / Clamping Range (mm) 夾接範圍OD			Max. WP (bar) 最大工作壓力		Product Length (mm) 產品長度L		
	ND	Inch	Actual OD (mm)	MJG / MJGL / MGLP MJSG / MJSGL / MJET	MJS / MJL / MJR / MJRL MJH / MJHL / MJHT	MJD / MJDL / MJER	Ship 船	Industry 一般工業	MJER 彎管版	Standard 標準版	Long 加長版
23	65A-1		73.0	71.5 ~ 74.1	72.5 ~ 75.5	71.5 ~ 76.5	14	28	40	80	150
24	65A	2 1/2	76.1 76.3	75.0 ~ 77.2	75.0 ~ 78.0	75.0 ~ 79.0					
25	65A-3		69.0 70.0	68.0 ~ 70.1	68.5 ~ 71.0	67.5 ~ 72.0					
26	65A-4		66.7	65.2 ~ 67.3	65.4 ~ 68.3	64.4 ~ 69.0					
27	80A-1		84.0 85.0	83.0 ~ 84.9	82.5 ~ 85.5	81.0 ~ 86.0					
28	80A	3	88.9 89.1	87.8 ~ 91.0	88.0 ~ 91.0	86.0 ~ 92.0					
30	80A-4		79.9	78.8 ~ 80.8	78.8 ~ 82.0	77.0 ~ 83.0					
32	90A	3 1/2	101.6	100.4 ~ 102.6	100.0 ~ 103.0	100.0 ~ 104.0					
34	100A-1		104.0	103.0 ~ 104.8	102.0 ~ 105.0	102.0 ~ 106.0					
35	100A-2		108.0	106.5 ~ 108.5	106.0 ~ 109.0	106.0 ~ 110.0					
36	100A	4	114.3	113.2 ~ 115.4	113.0 ~ 116.0	113.0 ~ 118.0					
37	100A-4		106.3	105.0 ~ 107.4	105.0 ~ 107.5	105.0 ~ 108.5					
38	100A-5		110.0	108.5 ~ 111.0	108.5 ~ 111.5	108.5 ~ 113.5					
39	125A-1		133.0	131.6 ~ 134.4	131.0 ~ 135.0	131.0 ~ 135.5					
40	125A	5	139.7 139.8	137.7 ~ 140.9	138.0 ~ 142.0	138.0 ~ 142.5					
41	125A-3		141.1 141.3	139.7 ~ 142.5	139.5 ~ 143.5	139.5 ~ 144.0					
42	125A-4		127.0	125.6 ~ 128.4	125.0 ~ 129.0	125.0 ~ 129.5					
43	125A-5		129.0	127.5 ~ 130.0	127.5 ~ 130.0	127.5 ~ 131.0					
Q2	125A-9		125.0	123.0 ~ 126.0	123.0 ~ 126.0	123.0 ~ 126.5					
S4	125A-12		130.2	128.8 ~ 131.6	129.0 ~ 131.0	128.2 ~ 132.7					

藍字粗體標示為標準尺寸

船用爆破壓力 \geq 工作壓力 x 安全係數 (4)

工業用爆破壓力 \geq 工作壓力 x 安全係數 (2)

※不建議在食品輸送管線使用，橡膠墊圈可能會導致堵塞及腐爛。

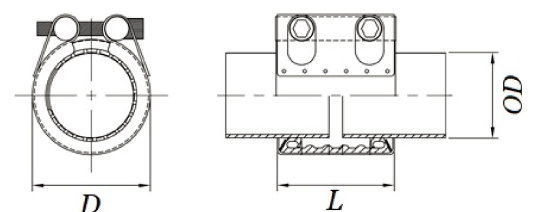



規格尺寸對照 止漏管夾/銜接管夾

Item No.	Pipe Outside Diameter 管外徑			Coupling / Clamping Range (mm) 夾接範圍OD			Max. WP (bar) 最大工作壓力		Product Length (mm) 產品長度L		
	ND	Inch	Actual OD (mm)	MJG / MJGL / MGLP MJSG / MJSGL / MJET	MJS / MJL / MJR / MJRL MJH / MJHL / MJHT	MJD / MJDL / MJER	Ship 船	Industry 一般工業	MJER 彎管版	Standard 標準版	Long 加長版
44	150A-1		154.0	151.5 ~ 155.0	151.5 ~ 155.5	151.5 ~ 156.0					
45	150A-2		159.0	156.5 ~ 160.0	156.0 ~ 160.0	156.0 ~ 161.0					
46	150A	6	165.2	163.3 ~ 166.7	164.0 ~ 167.0	164.0 ~ 168.5	12	24	60	111	201
47	150A-4		168.3	166.6 ~ 170.0	166.0 ~ 170.0	166.0 ~ 170.5					
49	150A-6		150.0	147.5 ~ 151.0	148.0 ~ 152.0	146.8 ~ 152.5					
Q6	175A-1		180.0 181.0	178.0 ~ 182.0	178.0 ~ 182.0	178.0 ~ 183.0	10	20			
51	200A	8	216.3	214.5 ~ 218.3	214.0 ~ 218.5	214.0 ~ 219.0					
52	200A-2		219.1	217.0 ~ 221.0	216.5 ~ 221.5	216.5 ~ 222.0					
54	200A-4		200.0	198.2 ~ 201.5	198.0 ~ 203.0	198.0 ~ 203.5					
55	200A-5		203.0 204.0	202.7 ~ 206.7	202.0 ~ 206.0	202.0 ~ 206.5	8	16			
56	250A	10	267.0 267.4	264.8 ~ 270.0	262.0 ~ 269.0	262.0 ~ 270.0					
57	250A-2		273.1 274.0	270.4 ~ 275.6	270.0 ~ 276.0	270.0 ~ 277.0					
59	250A-4		252.0 254.0	251.4 ~ 256.6	251.0 ~ 257.0	251.0 ~ 257.0					
61	300A	12	318.5	316.0 ~ 322.0	316.0 ~ 322.5	316.0 ~ 323.0			61	150	250
64	300A-2		323.9	321.0 ~ 327.4	322.0 ~ 328.0	322.0 ~ 329.0					
66	300A-6		304.0	301.5 ~ 306.6	301.5 ~ 308.0	301.5 ~ 309.0	7	14			
67	350A	14	355.6	352.0 ~ 360.0	352.0 ~ 359.5	352.0 ~ 361.0					
71	400A	16	406.4	402.0 ~ 410.0	402.0 ~ 410.0	402.0 ~ 411.0					
74	450A	18	457.2	-	453.0 ~ 460.0	453.0 ~ 462.0	6	12			
77	500A	20	508.0	-	504.0 ~ 512.0	504.0 ~ 513.0	5	10			
80	550A	22	558.8	-	555.0 ~ 563.0	554.0 ~ 564.0	4.6	9.2			

藍字粗體標示為標準尺寸

船用爆破壓力 \geq 工作壓力 x 安全係數 (4)

工業用爆破壓力 \geq 工作壓力 x 安全係數 (2)

※不建議在食品輸送管線使用，橡膠墊圈可能會導致堵塞及腐爛。

